



CARSURIN

1968

IPT CARSURIN Tbk Public Expose

28 June 2024

Disclaimer

This report and any electronic access hereto are restricted and intended only for the clients and related entities of PT CARSURIN Tbk. This report is only for information and recipient use. It shall not be reproduced, copied, or made available to others. Under no circumstances shall this document be considered as a selling offer or solicitation of securities buying.

PT CARSURIN Tbk, its affiliated companies, officers and employees are held harmless from any responsibility and liability for claims, proceedings, actions, losses, expenses, damages, or costs filed against or suffered by any person as a result of acting pursuant to the contents hereof.

Neither is PT CARSURIN Tbk, its affiliated companies, officers nor employees liable for errors, omissions, misstatements, negligence, or inaccuracy contained herein.



CARSURIN
1968

Company Overview



INTEGRITY



TRUST



DISCIPLINE



DETERMINATION



STRETCH



SPEED

What is TIC?

Testing, Inspection & Certification

Shielding Against Risk & Ensuring Products & Services Meet Safety, Quality, And Regulatory Standards

ROLE OF TIC:



Empowering
Global Trade



Mitigating
Risk



Trusted Partner for
Business &
Government



Key
Protector of
Consumers



Ensuring Product
Safety, Quality, &
Compliance



TESTING

A Rigorous Process to Assess
Safety, Functionality & Quality
- *Compliance to Regulatory
Standards & Specs.*



INSPECTION

Evaluation of Products,
Processes & Operations to
Identify Potential Issues Before
Escalated.



CERTIFICATION

A Seal of Approval that the
Product/Service Passed
Stringent Local,
International &/or
Regulatory Standards.

FINANCIALS

- **REV CAGR: 2018-2023: 14%**



- Established 1968
- Driven By Core Values
- 1st TIC Indonesian Company to Tbk
- Market Leader



55+ Years of Knowledge & Experience

- Local & Market Knowledge
- Mitigating Risks
- Technical & Non-Technical Issues
- Customized Solutions



Team

- Competent & Professional
- 1021 Team Members
- Internal Audited



Labs & Offices

- 20 Branch Offices
- 17 Laboratories



Accreditation

- TIC Council Membership
- ISO & KAN Accredited



Products & Deliverables

- Certificates & Reports
- Data Analysis

55+
Years
Experience



INTEGRITY



TRUST



DISCIPLINE



DETERMINATION

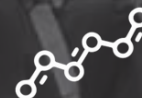

STRETCH



SPEED



CARSURIN
1968



FLORA REGIAN
President Commissioner



GUSMARDI BUSTAMI
Independent Commissioner



SHEILA TIWAN
President Director



TIMOTIUS TJAHJANA
Director



ERWIN MANURUNG
Director



HAROLD LOEVY
Advisor

Milestones

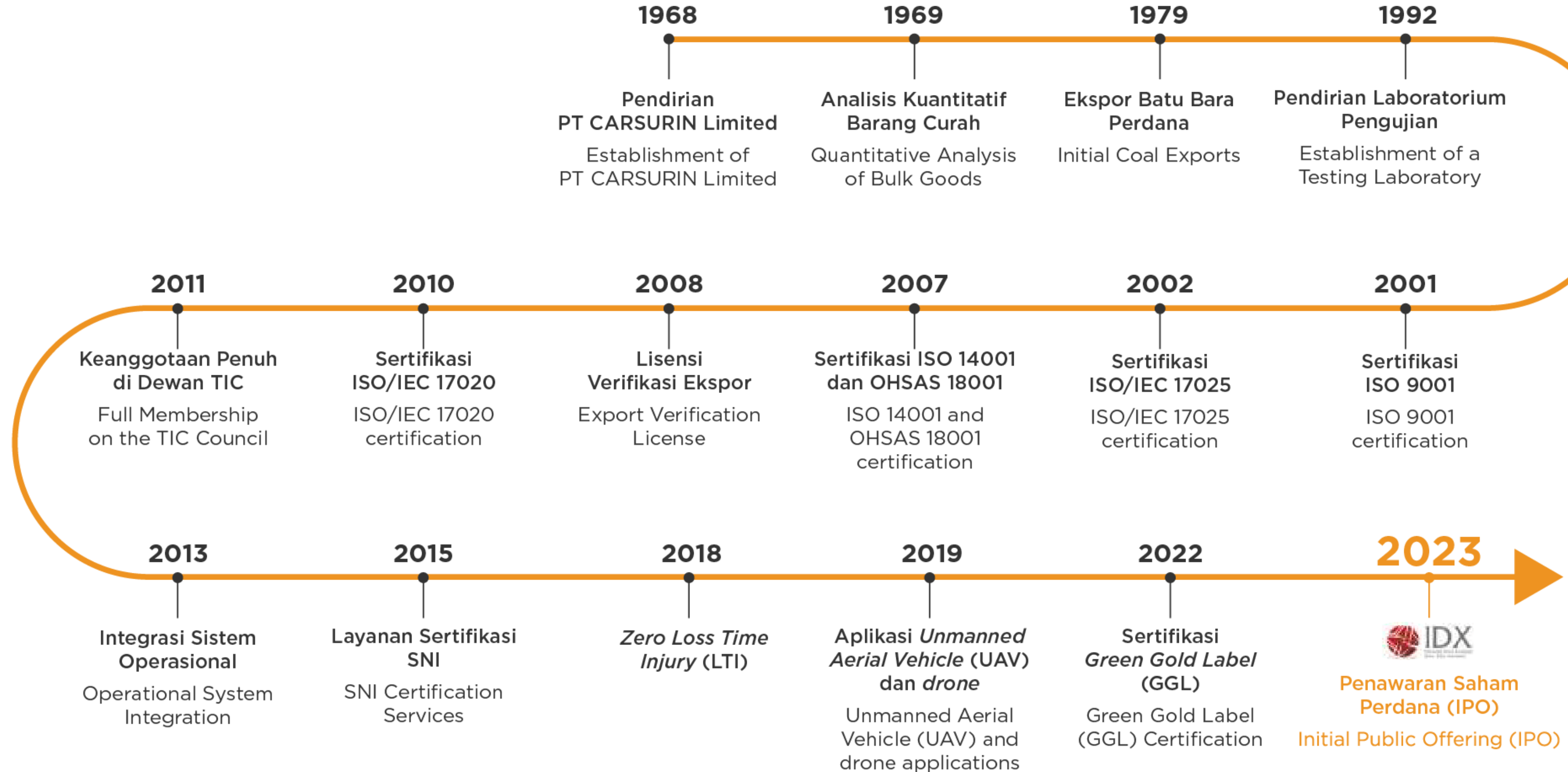

Our Shareholders

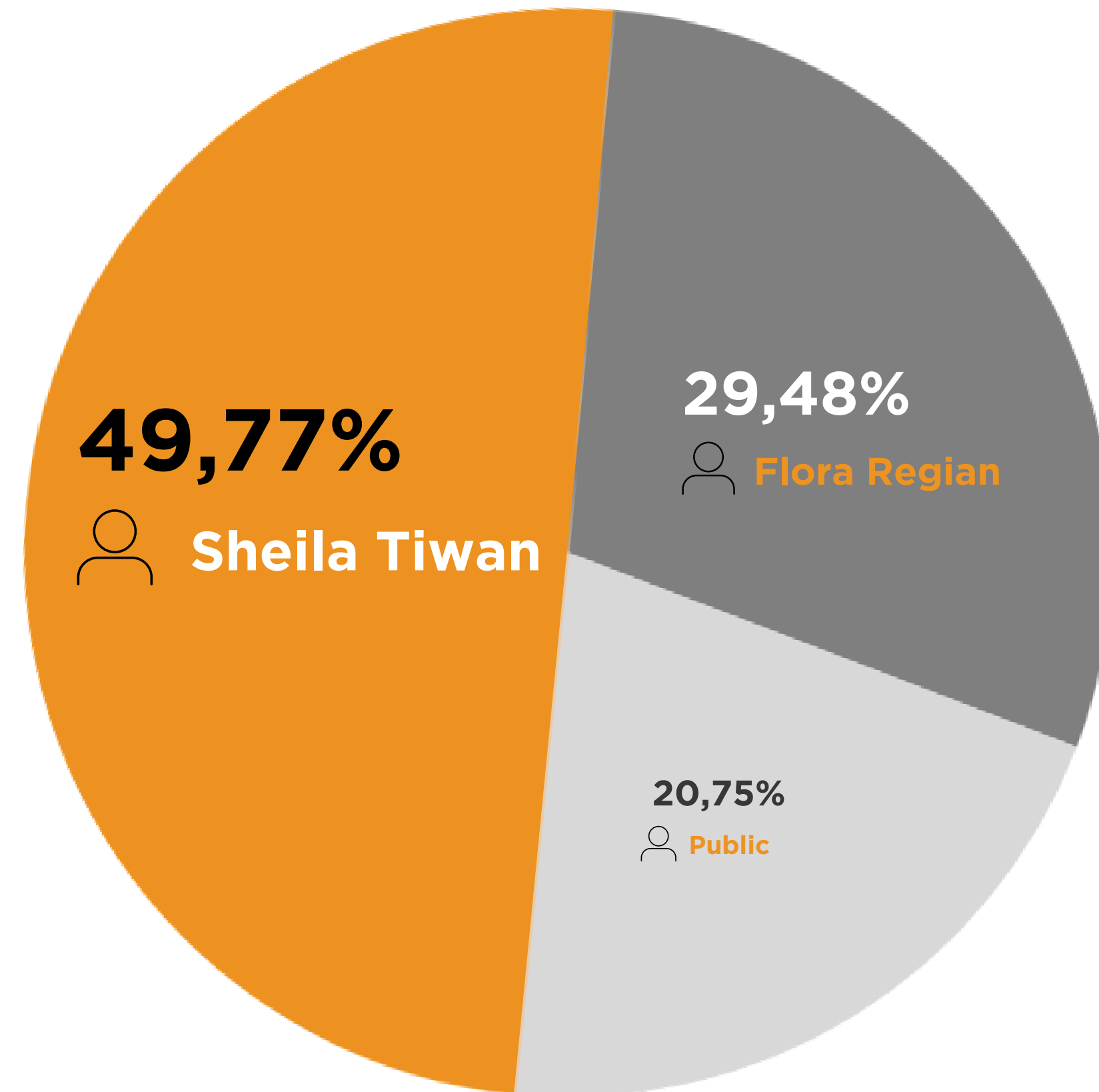



CARSURIN
1968

Business Strategy



INTEGRITY



TRUST



DISCIPLINE



DETERMINATION

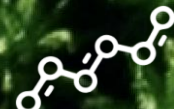

STRETCH



SPEED

Growth Opportunities

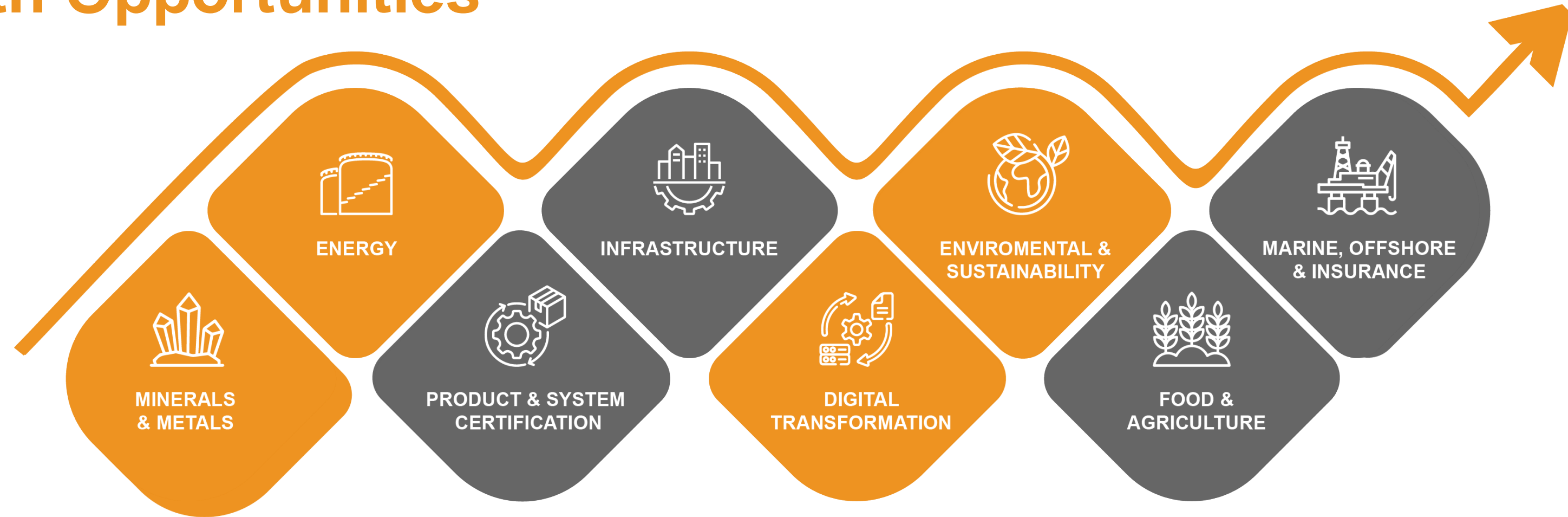

Green Economy		Blue Economy	Energy Transition
<i>Climate Change Mitigation</i>	<i>EV Ecosystem</i>		
Environmental Testing	Ni Ore Value Chain	Marine Infrastructure	Energy Efficiency Audit
Carbon Footprint	EV Battery Testing	Maritime Transport	UAV Digital Transformation
GHG Certification	Downstream Electrification	Dangerous Goods	Biofuels, PKS, GGL
Carbon Trading	Human Resource Development		

Services to Support Transforming the Economy Towards Resilient and Sustainable Economic Growth

Update on Growth Opportunities

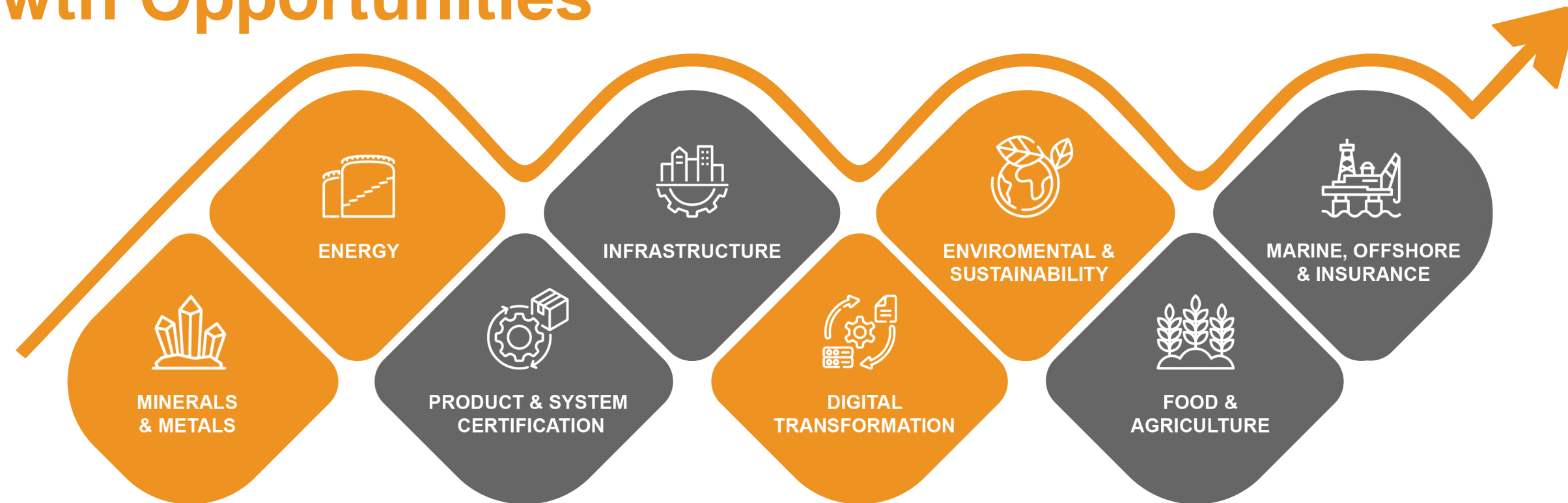

Climate Change Mitigation

GHG Certification: LVV & NEK Accreditation

EV Ecosystem

Ni Ore Value Chain: major clients extend contract

EV Battery Testing: NBRI Strategic Alliance

EV Battery Testing: Launching Test Lab for 2-wheeler

Energy Transition

UAV Digital Transformation: key contracts (2) with Vale

UAV Digital Transformation: new products DJI Dock2, Flycart

GGL: continued expansion R.I., Japan, Malaysia

Petrochem: major tender success for LS import/export



CARSURIN
1968

Operation Highlights



INTEGRITY



TRUST



DISCIPLINE



DETERMINATION

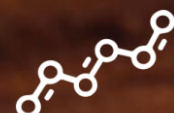

STRETCH



SPEED

Locations by Division & Branches

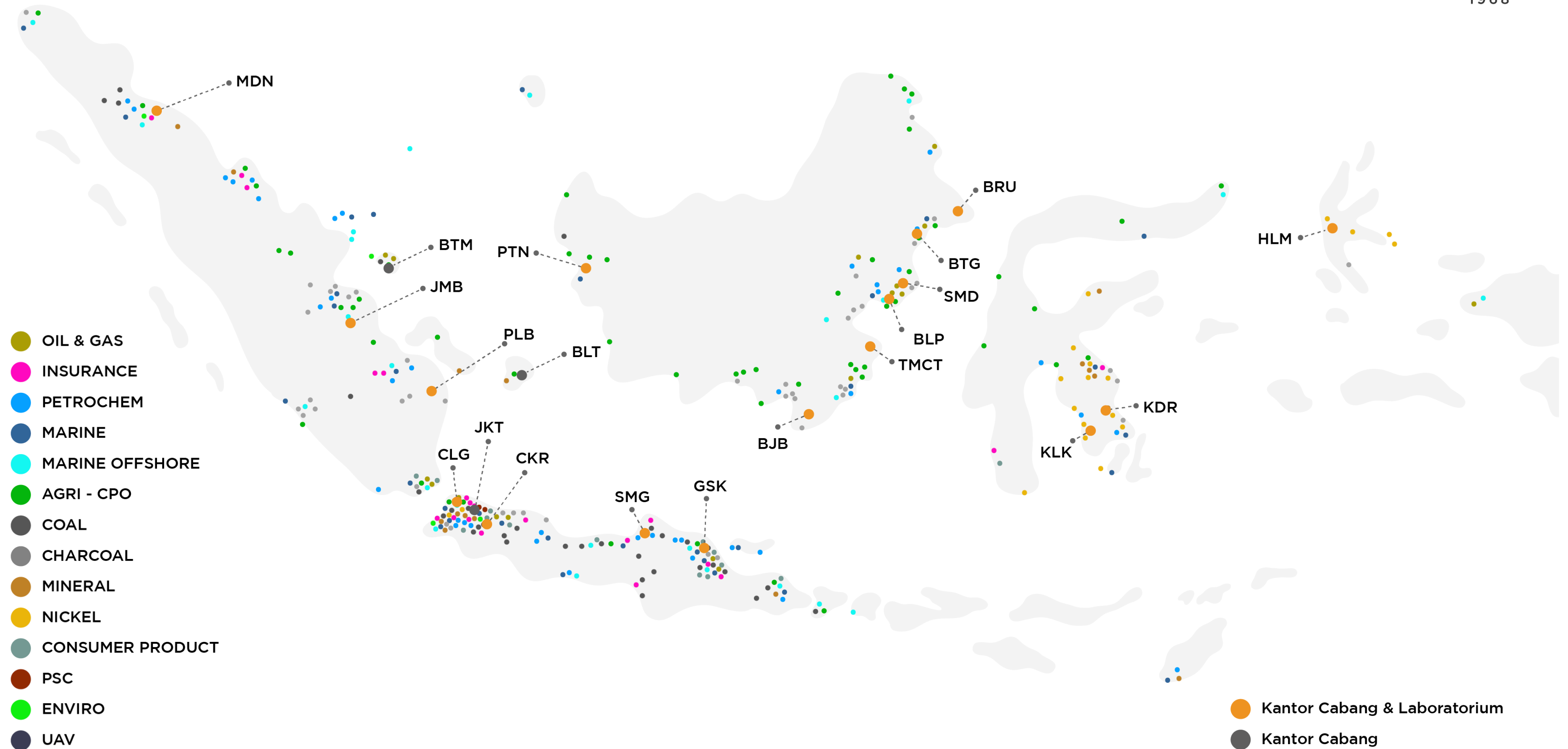

Branch Revitalisation



New Branch



JAMBI



MEDAN



GRESIK

On Progress

JAKARTA

4 Ruko 4 Lantai, Luas: 1.525,6 m²



KABUPATEN BOGOR

Luas Indoor: 636,4 m²



KOLAKA

Luas: 4.400 m²

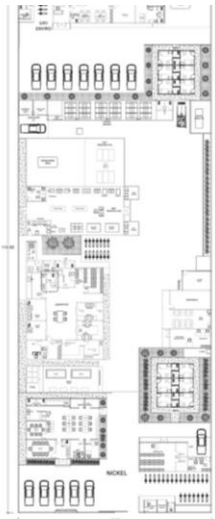
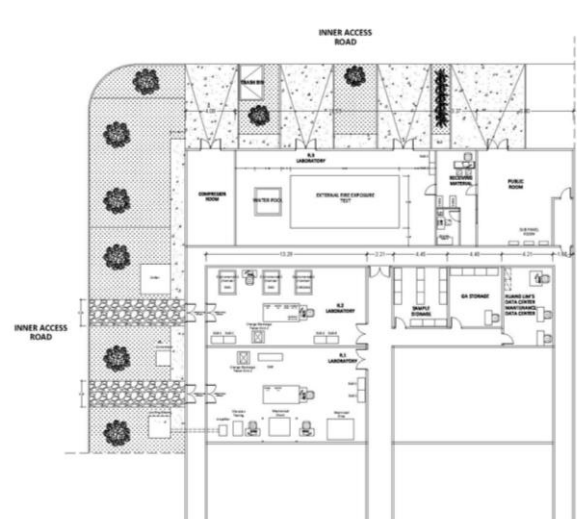
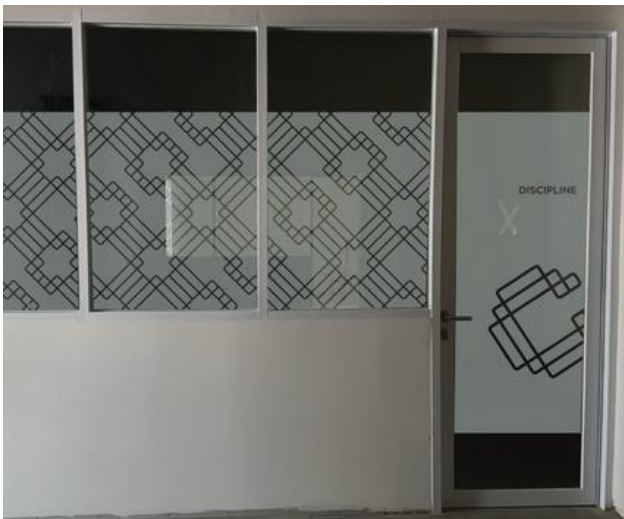
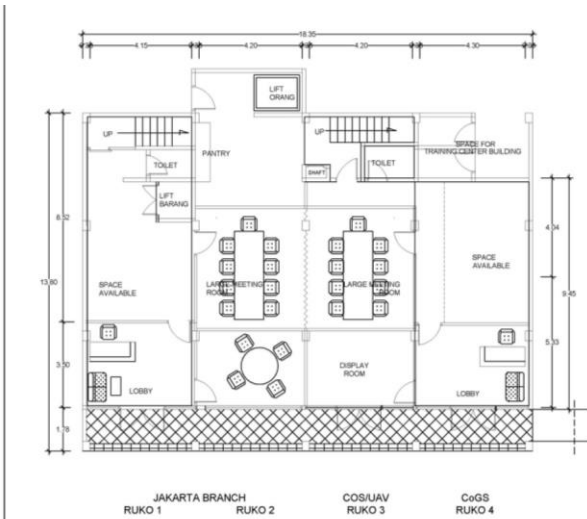



CARSURIN
1968

Financial Highlights



INTEGRITY



TRUST



DISCIPLINE



DETERMINATION

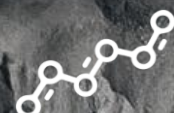

STRETCH



SPEED



Revenue – Service Type

SERVICE TYPE – ANNUALLY
(IDR BILLIONS)

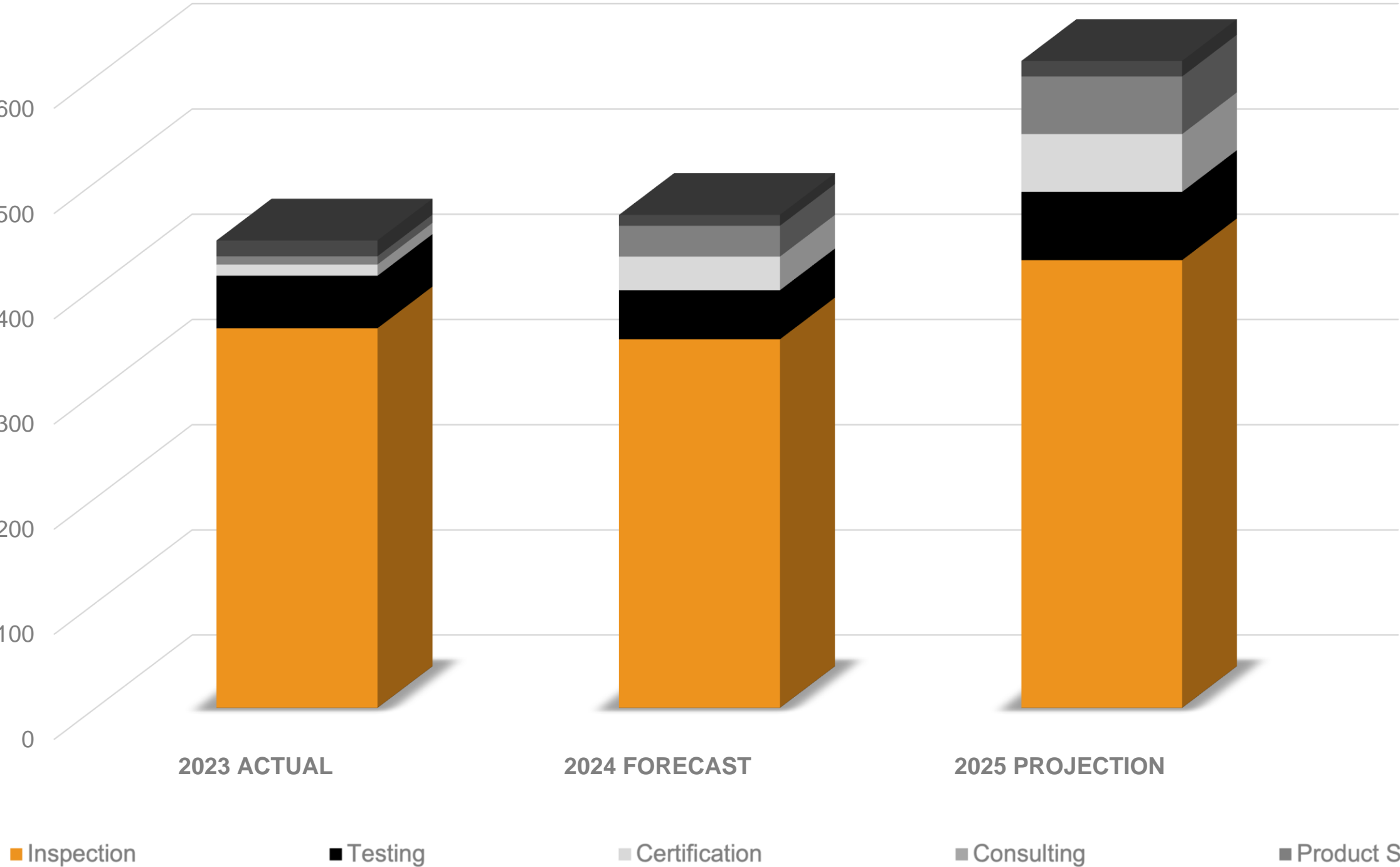

Service Type	2023 ACTUAL	2024 FORECAST	2025 PROJECTION
Inspection	361.01	350.52	425.70
Testing	49.86	46.65	64.88
Certification	10.67	31.92	54.91
Consulting	7.86	29.31	54.74
Product Sales	15.03	10.30	14.77
Total Revenue	444.43	468.71	615.00

Profit & Loss



PROFITABILITY – ANNUALLY
(IDR BILLIONS)

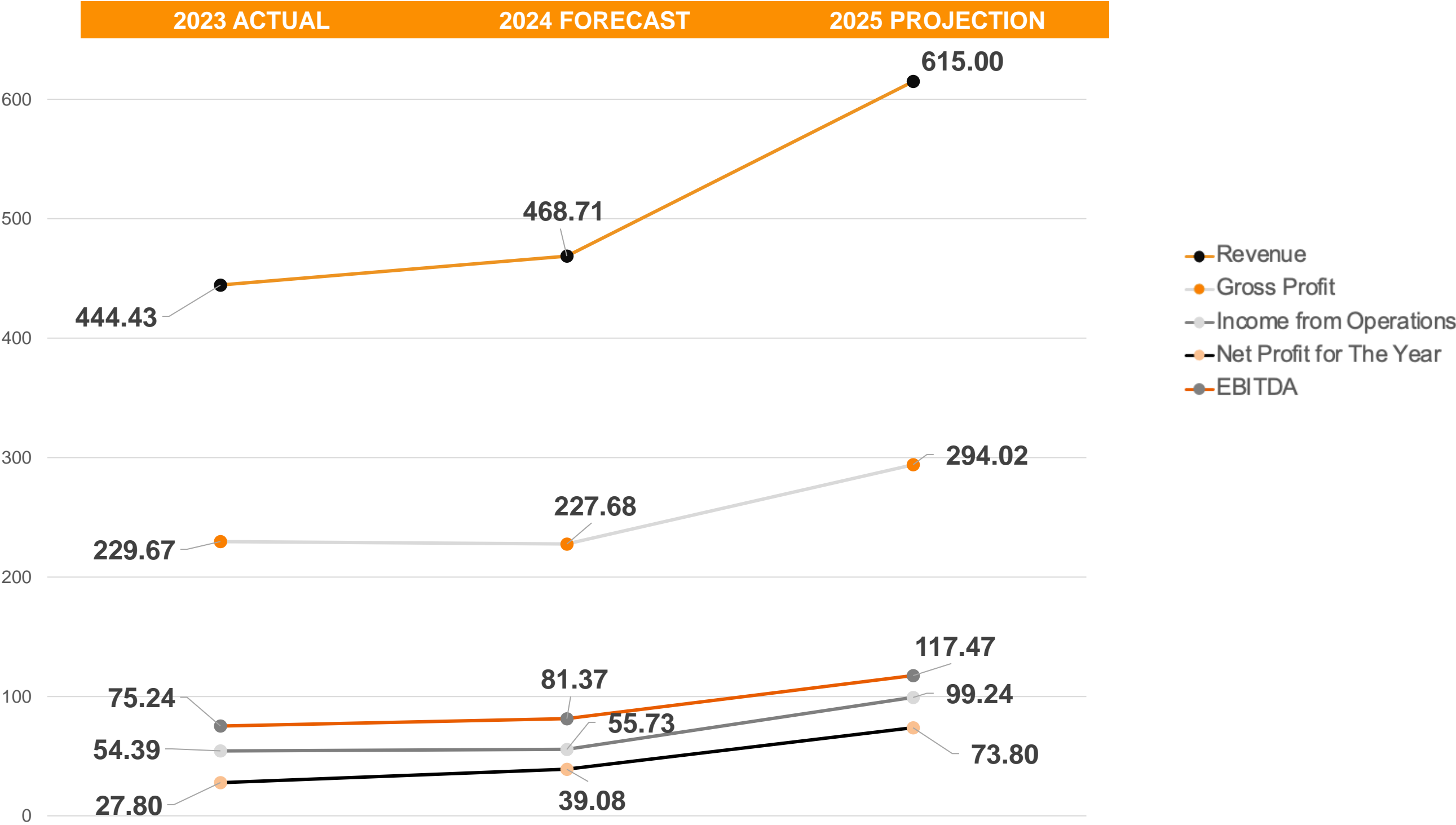

2023 ACTUAL	2024 FORECAST	2025 PROJECTION
444.43	468.71	615.00
229.67	227.68	294.02
54.39	55.73	99.24
27.80	39.08	73.80
75.24	81.37	117.47

Margin



MARGIN – ANNUALLY
(IN PERCENTAGE)

2023 ACTUAL

2024 FORECAST

2025 PROJECTION

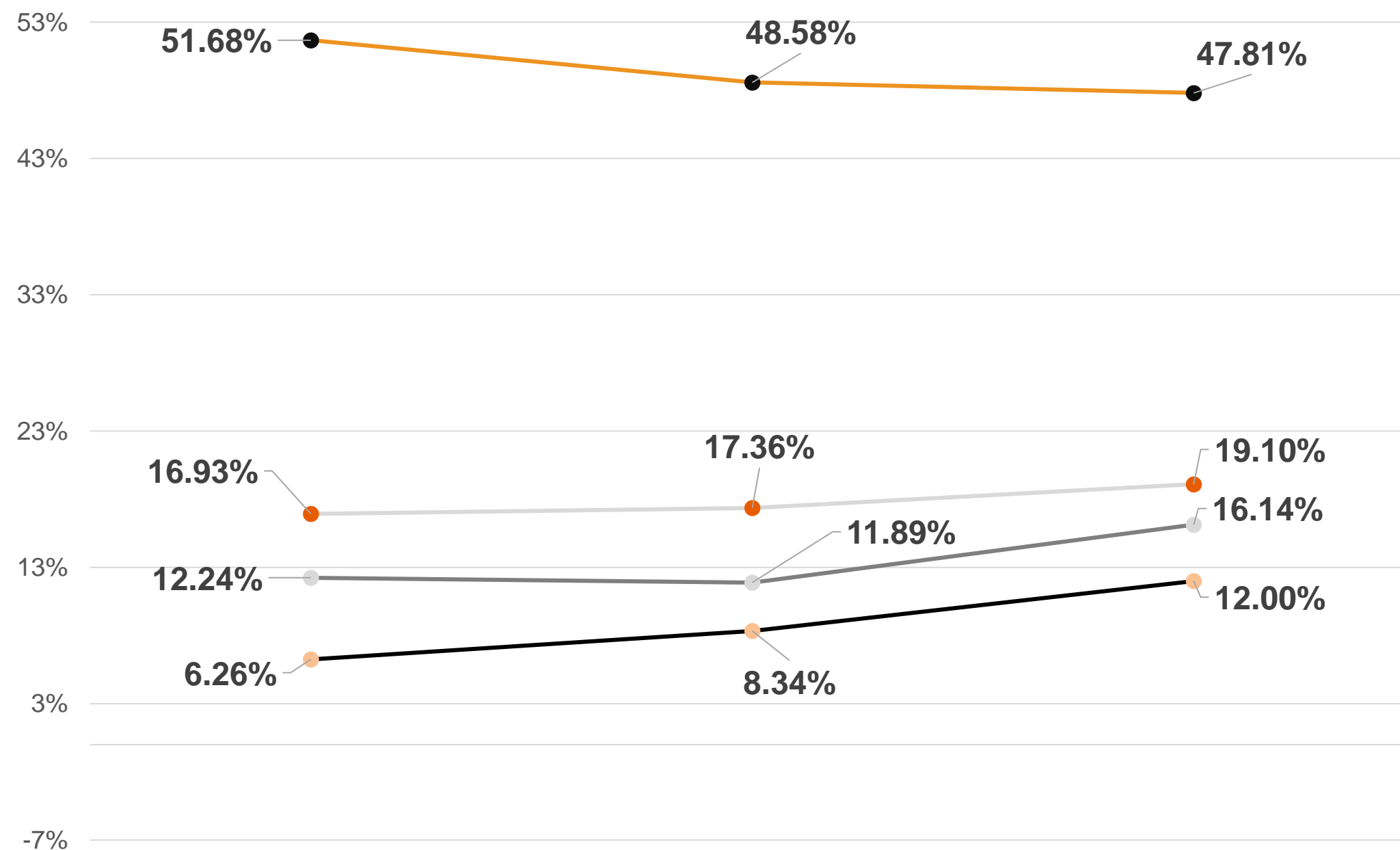

- Gross margin
- Operating margin
- Net margin
- EBITDA margin

	2023 ACTUAL	2024 FORECAST	2025 PROJECTION
Gross margin	51.68%	48.58%	47.81%
Operating margin	12.24%	11.89%	16.14%
Net margin	6.26%	8.34%	12.00%
EBITDA margin	16.93%	17.36%	19.10%



Cash Flow



CASHFLOW – ANNUALLY
(IDR BILLIONS)

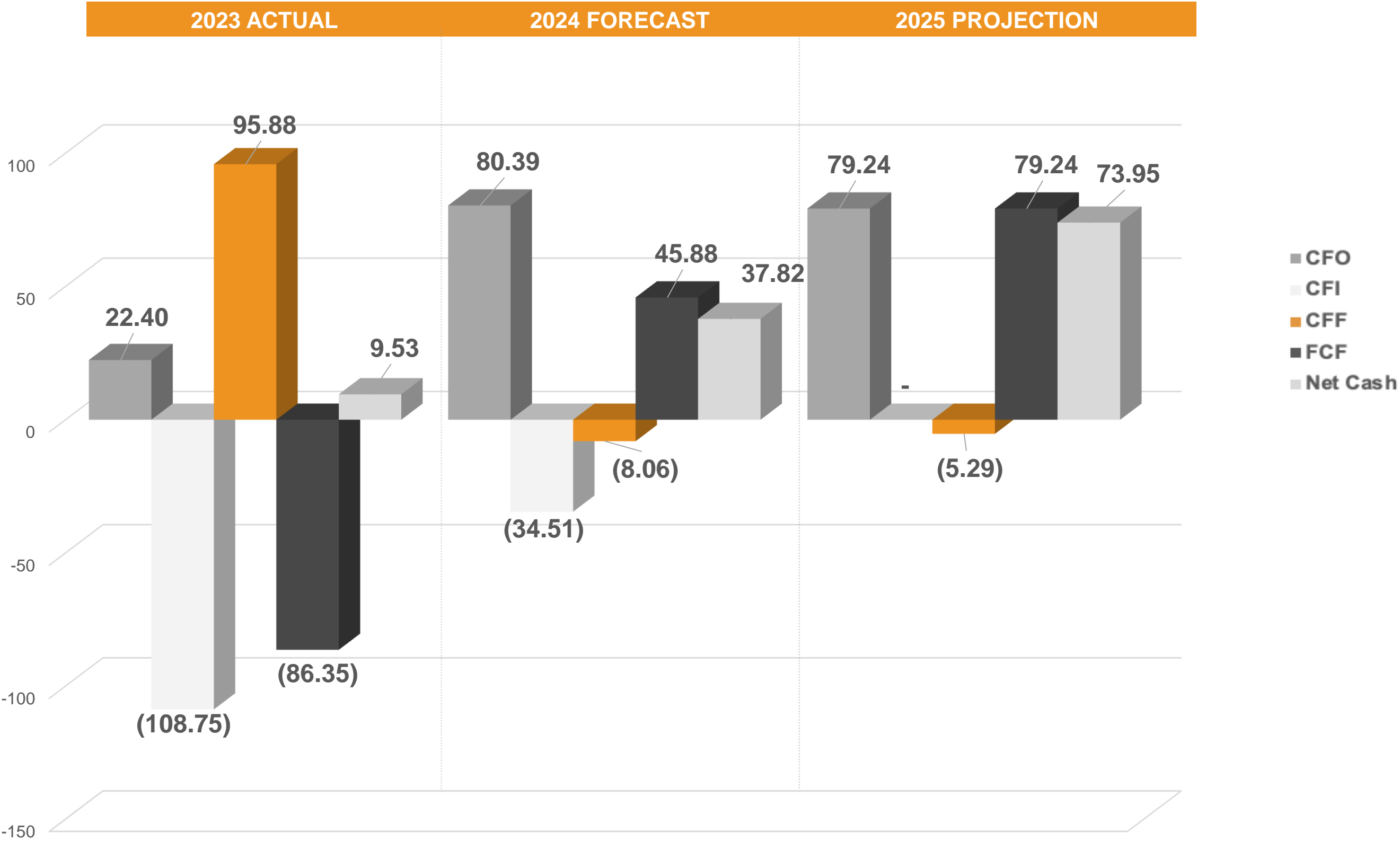

2023 ACTUAL	2024 FORECAST	2025 PROJECTION
22.40	80.39	79.24
(108.75)	(34.51)	-
95.88	(8.06)	(5.29)
(86.35)	45.88	79.24
9.53	37.82	73.95



Financial Position

ASSET, LIABILITIES & EQUITY – ANNUALLY
(IDR BILLIONS)

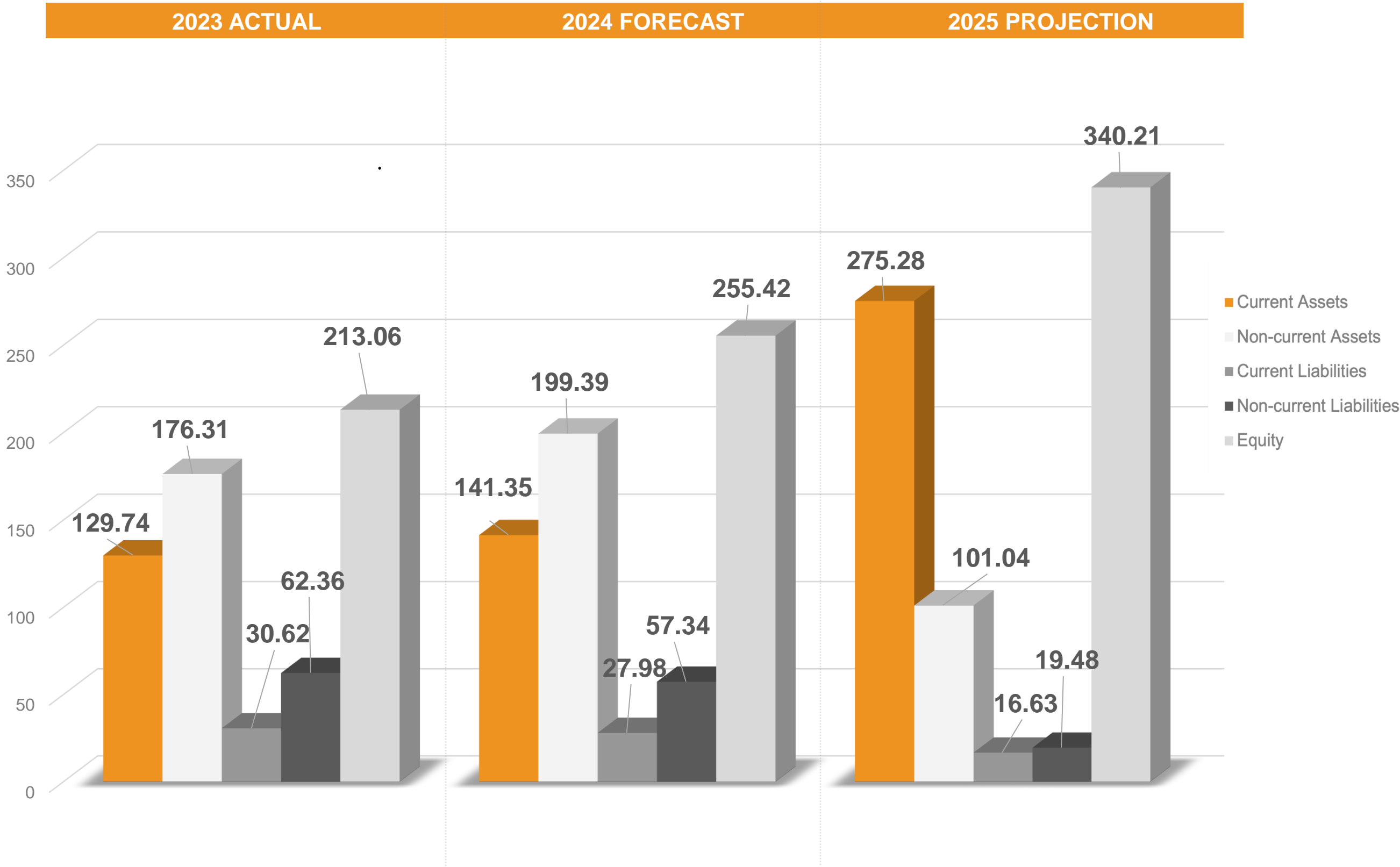

2023 ACTUAL	2024 FORECAST	2025 PROJECTION
129.74	141.35	275.28
176.31	199.39	101.04
30.62	27.98	16.63
62.36	57.34	19.48
213.06	255.42	340.21



Financial Ratio

ROE & ROA

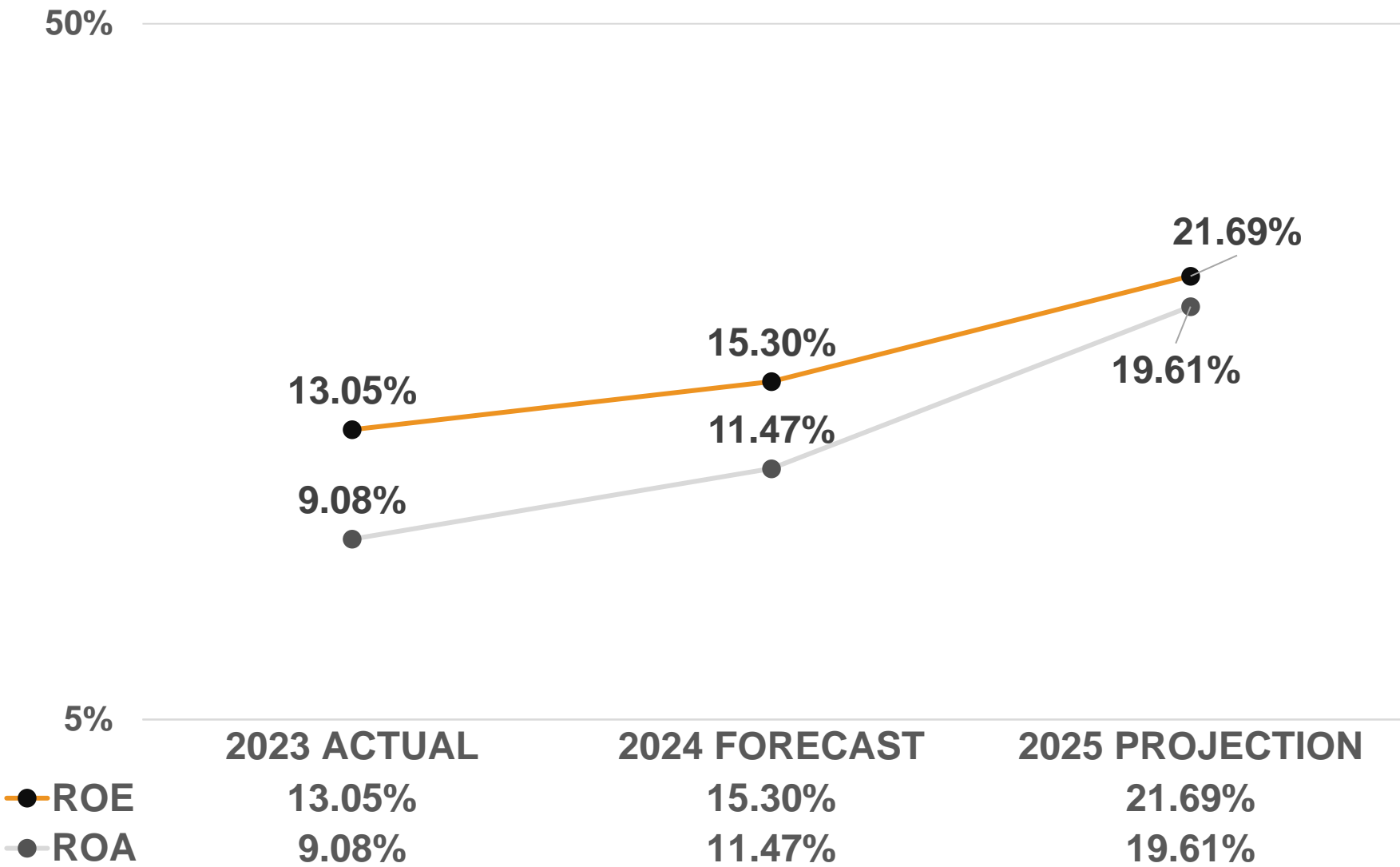

DEBT TO EQUITY RATIO

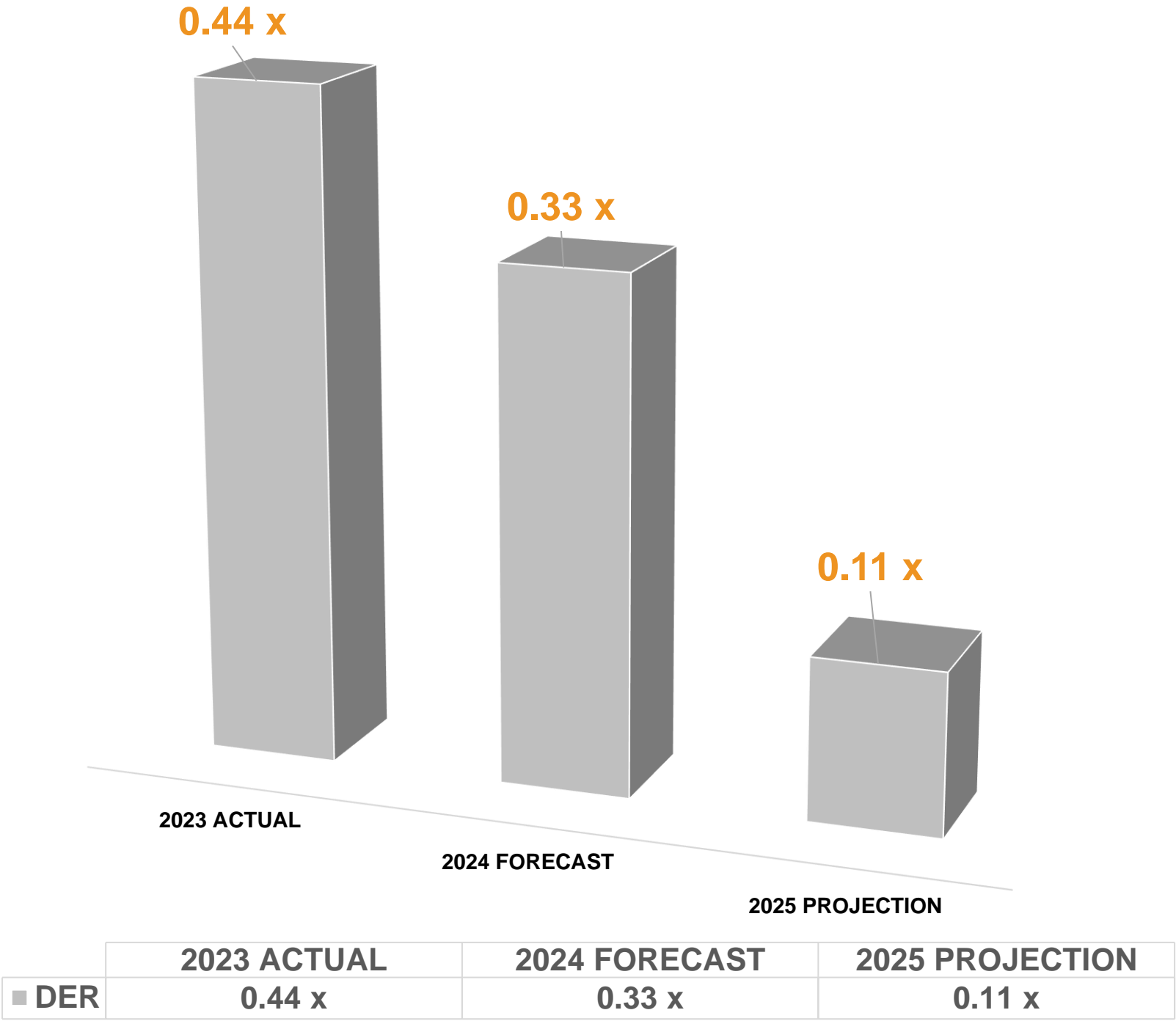



CARSURIN
1968

Thank You



INTEGRITY



TRUST



DISCIPLINE



DETERMINATION



STRETCH



SPEED

© PT CARSURIN Tbk – 2024 – All Rights Reserved